

# Data Sheet

## Lithium Manganese Dioxide Battery

### CR2032 (Power Type)

#### Specifications

Nominal Voltage	3V
Nominal Capacity ①	220(mAh)
Continuous standard load	15(K $\Omega$ )
Standard Current	0.2(mA)
Continuous Current (Max) ②	6(mA)
Pulse Current (Max) ③	20(mA)
Operating temperature	-30~60 $^{\circ}$ C
Weight	3.2(g)

#### Dimensions (mm)

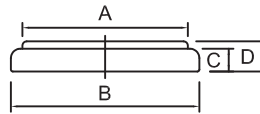

A	$\phi$ 17.5
B	$\phi$ 20.0 $\begin{matrix} +0.0 \\ -0.3 \end{matrix}$
C	2.46(Ref.)
D	3.2 $\begin{matrix} +0.0 \\ -0.3 \end{matrix}$

- ① Nominal Capacity is determined to an end of 2.0V when the battery is allowed to discharge at a standard Load level at 23 $^{\circ}$ C
- ② Current Value is determined to be the level at which 40% of the nominal capacity is obtained with an end voltage of 2.0V at 23 $^{\circ}$ C
- ③ Current Value for obtaining 2.0V cell voltage when pulse is applied for 15seconds at 40% discharge depth at 23 $^{\circ}$ C

#### Discharge Characteristics

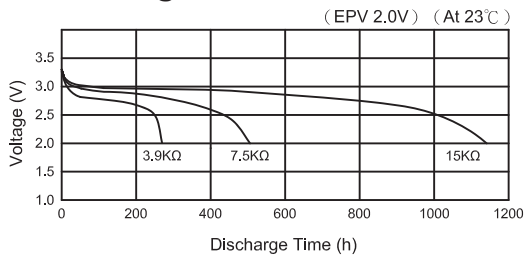

#### Temperature Characteristics

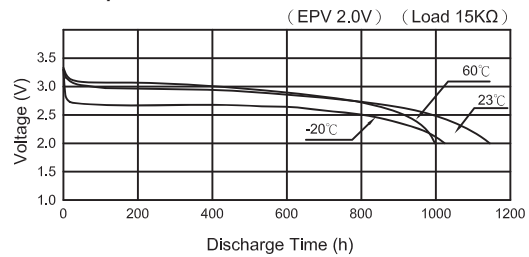

#### Pulse Discharge Characteristics

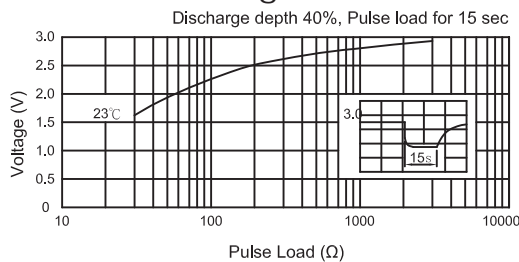

#### Load vs Capacity

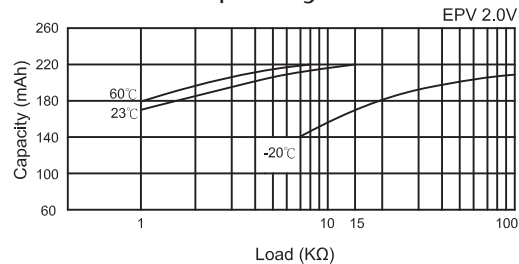

#### Discharge Characteristics CR2032 (Normal Type)

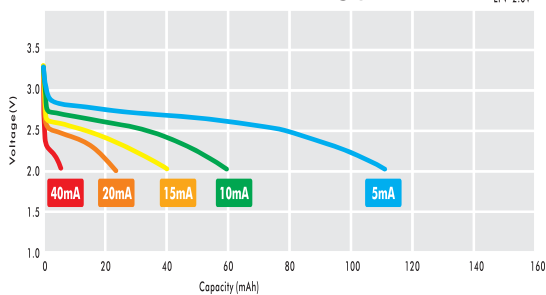

#### Discharge Characteristics CR2032 (Power Type)

