

Data Sheet

Lithium Manganese Dioxide Battery

CR2032 (Normal Type)

· Specifications

Nominal Voltage	3V
Nominal Capacity	220(mAh)
Continuous standard load	15(K Ω)
Operating temperature	-20°C~70°C
Weight	3.2(g)

Dimensions (mm)

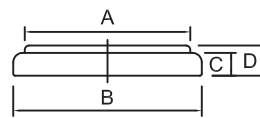

A	ϕ 17.5
B	ϕ 20.0 $\begin{matrix} +0.0 \\ -0.3 \end{matrix}$
C	2.46(Ref.)
D	3.2 $\begin{matrix} +0.0 \\ -0.3 \end{matrix}$

· Discharge Characteristics

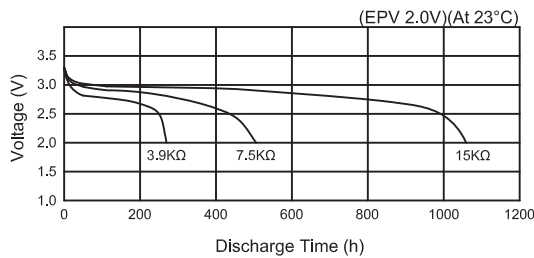

· Temperature Characteristics

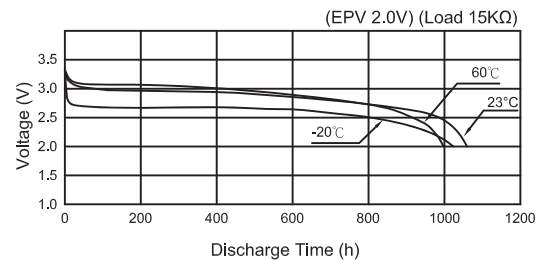

· Load vs Operating Voltage

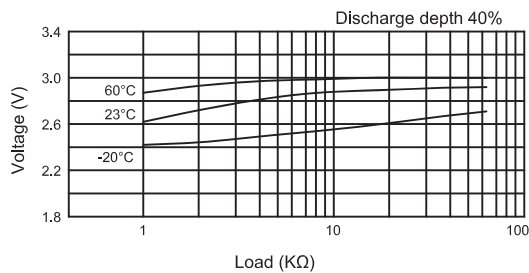

· Load vs Capacity

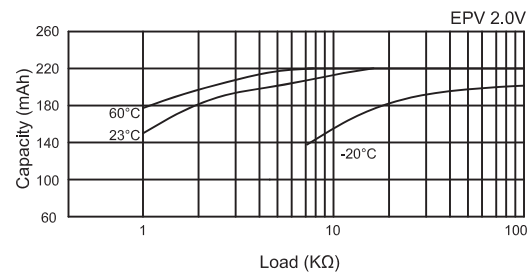

· Pulse Discharge Characteristics

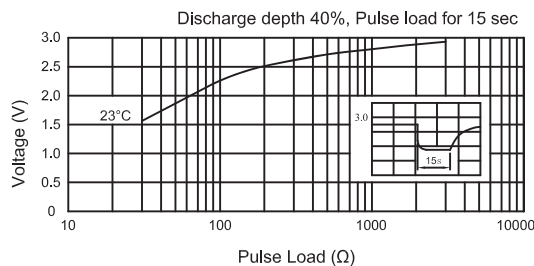

· Storage Characteristics

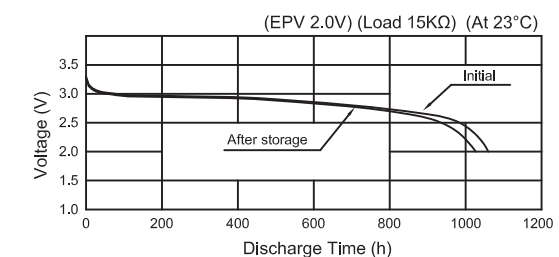

Storage at 60°C for 30 days equivalent to storage at room temperature for 18 months